



MEDHA INFRA

We build with Passion

Temple Bells



2 BHK Luxury Apartments @ Sangareddy

Typical Floor Plan:

965 sft



4' Private Balcony

Typical Floor Plan:

900 sft

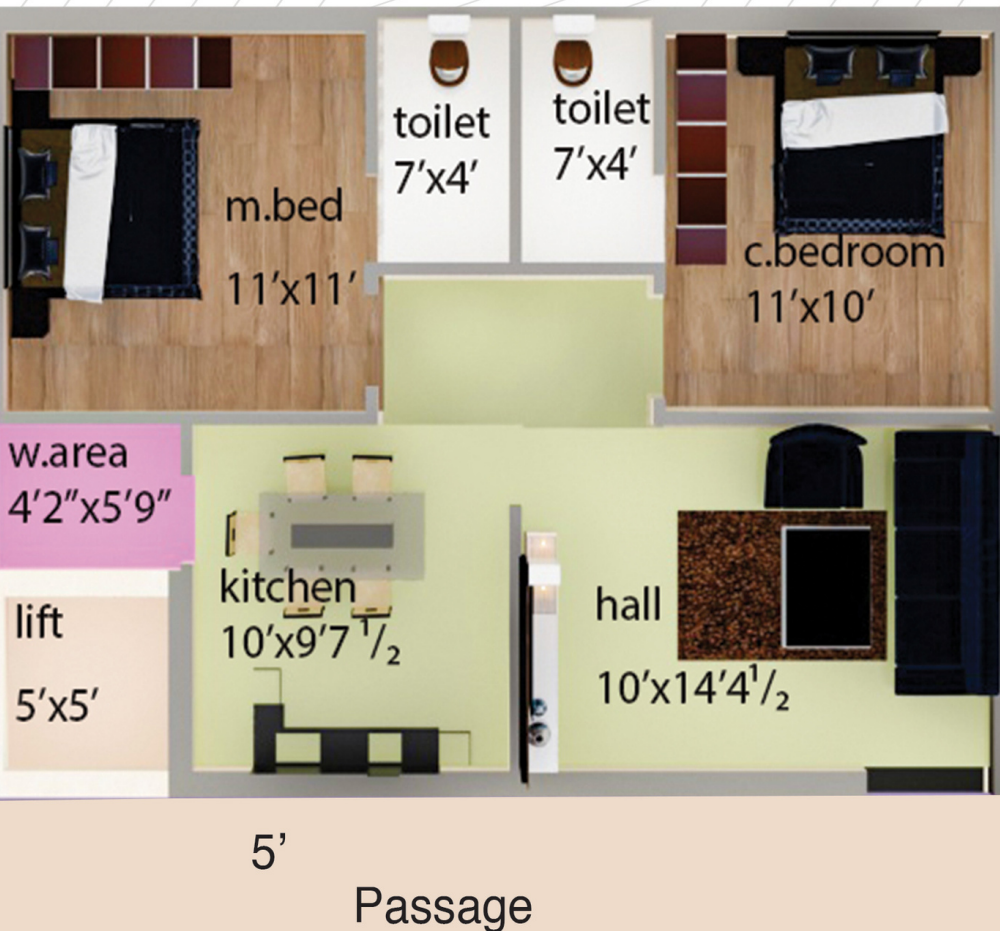

Typical Floor Plan:

980 sft



900 SFT



980 SFT



965 SFT





100% VASTU



CAR PARKING



GENERATOR

BEST PROPERTY FOR SALE

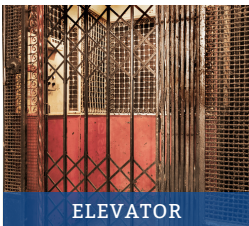

ELEVATOR

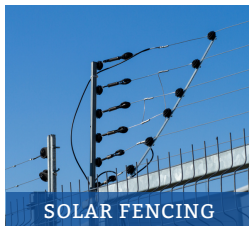

SOLAR FENCING



CCTV

SALIENT AMENITIES

DETAILS ABOUT PROPERTY

Situated in developing location
with scenic view

Best architectural
Standards

SPECIFICATIONS

- Structure**
RCC Framed Structure,
Super Structure,
Red Brick / aerocon fly ash bricks
- Plastering**
Plastering for all external and internal walls and Ceiling with 2 coats of Cement Mortar with Sponge Finishing
- Doors**
Main Door
Will have polished teak wood / Veneer Door
Internal Doors
Teak wood Frames with Skin Door and required powder coated Aluminum Hardware.
- Windows**
UPVC sliding frame
- Flooring**
Verified tiles (2x2) flooring for Living, Dining, Bedrooms and Kitchen with Skirting.
Anti skid Ceramic tile flooring for Balconies and Toilets.
- Painting**
All External walls of the building will have one coat of cement paint Followed by Two Coats of Exterior Paint.
Internal : 2 Coat Putty 1 Coat primer 2 Coat paint.
Best Quality Paints : Asian Paints/ Similar
- Kitchen**
Kitchen platform will have Black Granite with Built in Stainless steel Sink with 2' Heigh dado with matching Glazed Ceramic tiles.
- Toilets**
Ceramic Glazed tile dado up to door Height Level.
wall tiles 12 x 18 inches, 2 in 1 wall mixture unit in both Toilets,
Provision for Geyser Point in M. Bedroom Toilet or Common Toilet Exhaust Provision in both Toilets, All Sanitary with Standard Make (cera, Hindware, Asian) Stadar P.V.C pipe lines. All water lines with Standard CPVC
- Electrical**
TV and Telephone Points in the living Room and Master bedroom, AC point in all Bed Rooms and hall electrical wired (Fineolex, Standard modular switches) Legrand, Anchor, Foma all Basic Model. Electrical Wires: Fine Cab Polycab/Anchor/Finolex.
- Water Supply**
All the pipe lines will run from over head tank to Toilets and kitchen. Muncpal water provision in kitchen only.
- Stair Case**
Corridors & stair case with Granite tiles, with S.S. Railing.
- Lift**
1 Standard Lifts with Capacity of 6 Passengers
- Generator**
Generator Back-up for lift and Common areas. In flat one light and fan for all rooms

Note : Any Additional & Alterations are extra cost. GST and Registration charges as per government norms to be paid by customer. Corpus Fund - Rs. 15-25 per Sft. Maintenance extra.

Location Map:

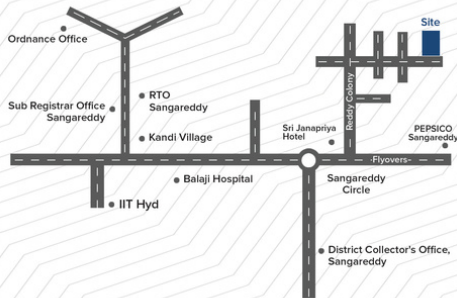

- 1) 0.5 KM from Sangareddy chowrasta.
- 2) 1 KM Collectors Office
- 3) 2 KM Balaji Hospital
- 4) 1 KM PepsiCo
- 5) 3 KM IIT Hyderabad

SCAN HERE



FOR LOCATION



Plot no. 31/1, Mallikarjuna Nagar,
Beside Padmarao Nagar,
Behind Indian Oil Petrol Bunk,
Isnapur, Sangareddy, Telangana - 502307

- Info@medhainfra.com
- 9949600333, 9515226605
- www.medhainfra.com

TS RERA NO :